

PROPERTY REPORT

# 419 Sunset Dr, Canton, GA 30114



Presented by

**Brenda Franklin** | REALTOR | SRS

Georgia Real Estate License: 421422



Mobile: (678)761-6699

Main: [Brenda@BrendaFranklin.com](mailto:Brenda@BrendaFranklin.com)

Agent: [www.BrendaFranklin.com](http://www.BrendaFranklin.com)

**Atlanta Communities Real Estate Brokerage**

9860 Highway 92  
Woodstock, GA 30188

# 419 Sunset Dr, Canton, GA 30114

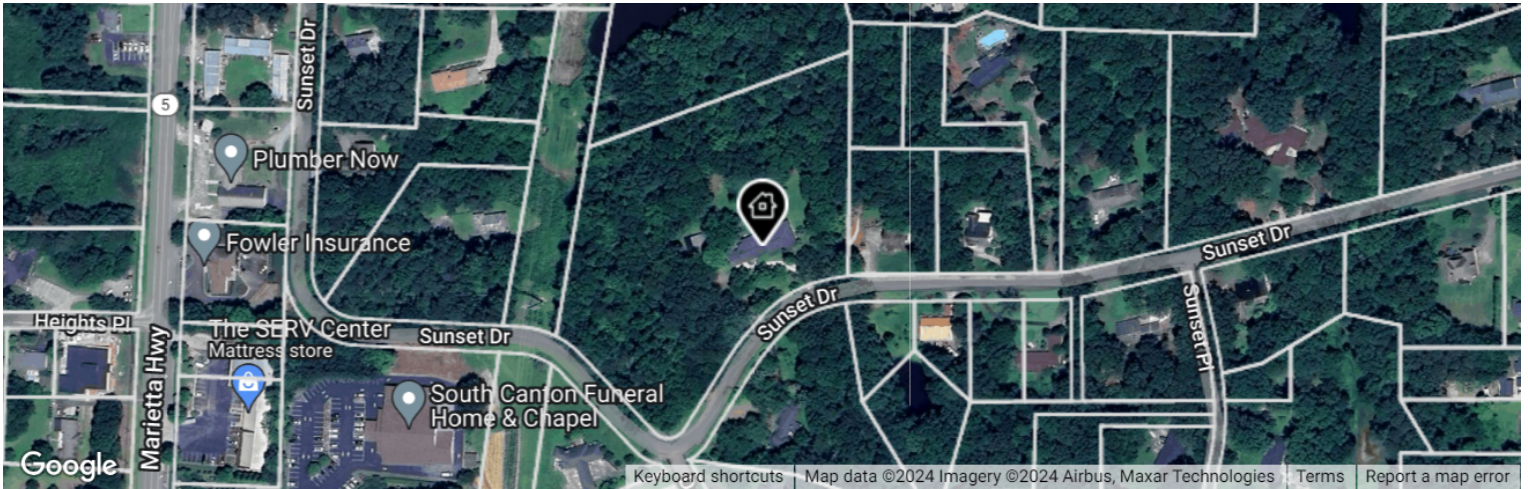

Legend: Subject Property

● Active • New, Active: 10/8/2024

## List Price

# \$850,000

Active Date: 10/8/2024  
Listing ID: 7468270

*This report contains data and information that is publicly available and/or licensed from third parties and is provided to you on an "as is" and "as available" basis. The information is not verified or guaranteed. Neither this report nor the estimated value of a property is an appraisal of the property. Any valuation shown in this report has been generated by use of proprietary computer software that assembles publicly available property records and certain proprietary data to arrive at an approximate estimate of a property's value. Some portions of this report may have been provided by an RPR user; RPR is not responsible for any content provided by its users. RPR and its information providers shall not be liable for any claim or loss resulting from the content of, or errors or omissions in, information contained in this report.*

## Home Facts

### Public Remarks

The home you have been waiting for! This large RANCH home on FINISHED basement has all the charm and character. Sitting on 5.5 acres in Cherokee County. NO HOA. Completely renovated with all the razzle dazzle. Stunning foyer that greets you and then enter into the oversized living room that has access to the grand, covered deck. Living room has custom built ins. Primary bedroom also has access to deck. Primary closet has custom closet system. 4th bedroom or FLEX room right off the kitchen, this room has access to the adorable sunroom on backside of home. Original MARBLE pieces in home from when it was built. So much fun history! OPEN CONCEPT kitchen, plenty of room to entertain. Custom cabinets with soft close drawers. This home has THREE fireplaces, one being in the kitchen. Grand island! Kitchen is right next to the beautiful breezeway where you can enjoy your coffee or wine down at the end of the day. Secondary bedrooms are spacious and have great closet space. Large picture windows throughout home. FINISHED basement has large rec room, full bathroom, fireplace, (stubbed for kitchenette) huge utility room! Access to the covered patio! Large garage and seller installed a detached garage/storage building with a second driveway! Plenty of room for all your toys and tools. Would be great for a boat/RV/ATV. FLAT backyard. Fire Pit for those nice cool nights. Perfect space to install a pool. Sellers installed a half-moon driveway. Great for guests! Small creek on the property. Beautiful producing garden in backyard. So many upgrades. New roof, new hvac, new doors, new garage doors, new paint, new kitchen, vapor barrier installed, new driveway. THIS HOME IS METICULOUSLY maintained. No other home like this. It is one of a kind. So many beautiful plants/flowers/trees planted all on property. Something is constantly blooming and its absolutely stunning the landscaping on the property. Convenient to Downtown Canton, First Fridays, The Mill, 575, shopping, restaurants, schools, parks! GREAT LOCATION. COME SEE ALL THE CHARM this home has to offer.

Home Facts	Public Facts	Listing Facts	Realtor Refinements
Property Type	<b>Single Family</b>	<b>Single Family</b>	-
Property Subtype	<b>Single Family Residential</b>	<b>Single Family Residence</b>	-
Bedrooms	<b>3</b>	<b>3</b>	-
Total Baths	<b>3</b>	<b>3</b>	-
Full Baths	<b>2</b>	<b>3</b>	-
Partial Baths	<b>1</b>	-	-
Living Area (sq ft)	<b>3,278</b>	<b>4,510</b>	-
Building Area (sq ft)	<b>3,278</b>	<b>4,510</b>	-
Lot Size	<b>5.53 acres</b>	<b>5.53 acres</b>	-
Lot Dimensions	<b>5.530 AC</b>	<b>x 675</b>	-
Garage	<b>Yes</b>	-	-
Garage (spaces)	<b>2</b>	<b>3</b>	-
Pool	-	<b>None</b>	-
Year Built	<b>1955</b>	<b>1955</b>	-
Style	<b>Ranch\Rambler</b>	-	-
Roofing	<b>Wood Shake / Shingles</b>	<b>Composition</b>	-
Heating	<b>Forced Air Unit</b>	<b>Central, Forced Air</b>	-
Cooling	<b>Central</b>	<b>Ceiling Fans, Central Air</b>	-
Fireplaces	<b>1</b>	<b>3</b>	-
Basement	<b>Unfinished Basement</b>	<b>Bathroom, Daylight, Exterior Access, Finished, Full, Interior Entrance</b>	-
Foundation	<b>Footing</b>	<b>Concrete Perimeter</b>	-
Exterior Walls	<b>Brick Veneer</b>	-	-
Number of Units	<b>0</b>	-	-
Number of Stories	<b>1 story with Basement</b>	<b>Two</b>	-

### Homeowner Facts

Owner Name (Public)	<b>Williams Christopher; Williams Patricia A</b>
Mailing Address	<b>419 Sunset Dr Canton GA 30114-3760</b>
Owner Occupied	<b>Yes</b>

## Extended Home Facts



Legend:  Subject Property

### Interior Features

<b>Appliance</b>	Gas Cooktop, Double Oven, Dishwasher, Range Hood, Gas Oven, Other
<b>Basement</b>	Exterior Access, Full, Interior Entrance, Bathroom, Finished, Daylight
<b>Cooling</b>	Ceiling Fans, Central Air
<b>Fireplace</b>	Basement, Family Room
<b>Floor</b>	Hardwood
<b>Heating</b>	Forced Air, Central
<b>Laundry</b>	Main Level, Other
<b>General</b>	Beamed Ceiling(S), Book Cases, Walk-In Closet, Double Vanity
<b>Window</b>	Insulated Windows
<b>Room Details</b>	Sun Room, Office, Workshop

### Interior Details

<b>Basement Unfinished</b>	1232 sq ft
<b>Floor Cover</b>	Carpet, Vinyl
<b>Garage Finished</b>	650 sq ft
<b>Interior Walls</b>	Decorative/Custom
<b>Porch - Open</b>	304 sq ft
<b>Porch - Open</b>	440 sq ft
<b>Porch Enclosed</b>	372 sq ft

### Exterior Features

<b>Fence</b>	None
<b>Foundation</b>	Concrete Perimeter
<b>Horse Property</b>	None
<b>Patio</b>	Covered, Deck, Porch-Side, Front Porch, Patio
<b>Roof</b>	Composition
<b>Security</b>	Smoke Detector
<b>Pool</b>	None
<b>Road</b>	Asphalt
<b>Water Front</b>	None
<b>Parking</b>	RV Access/Parking, Garage, Driveway, Level Driveway, Kitchen Level Entry
<b>Sewer Levels</b>	Septic Tank Two

### Exterior Details

<b>Lot Size - Square Feet</b>	240887 sq ft
<b>Lot Size - Frontage Feet</b>	675.0 sq ft
<b>Lot Size - Acres</b>	5.530 ac
<b>Neighborhood Code</b>	15030
<b>Roof Type</b>	Hip

<b>Utilities</b>	Water Available, Other
<b>General</b>	Private Yard, Storage, Courtyard
<b>Lot Size Dimensions</b>	x 675

## Location Details

<b>Directions to Property</b>	GPS friendly
<b>Subdivision</b>	W S Hattendorf
<b>Zoning</b>	R-20
<b>Location Features</b>	Creek/Stream On Lot, Private, Corner Lot, Landscaped, Back Yard, Front Yard

## Other Details

<b>Building Condition</b>	Average
<b>Patio</b>	324
<b>Patio</b>	440
<b>Storage Bldg.</b>	900
<b>Storage Bldg.</b>	165

## Homeowners Association Info

<b>Association</b>	No
--------------------	----

## Miscellaneous Details

<b>Other Equipment</b>	None
<b>Other Structures</b>	Outbuilding, Shed, Rv/Boat Storage, Workshop

## Schools (based on location)

<b>Elementary School</b>	Hasty Elementary School
<b>Middle School</b>	Teasley Middle School
<b>High School</b>	Cherokee High School
<b>School District</b>	Cherokee County School District

## AARP Livability™ Index for 30114

This chart rates the overall livability of a selected ZIP code on a scale from 0 to 100. AARP Livability™ is a trademark of AARP Inc.

Data Source: [AARP](#)

Update Frequency: Annual

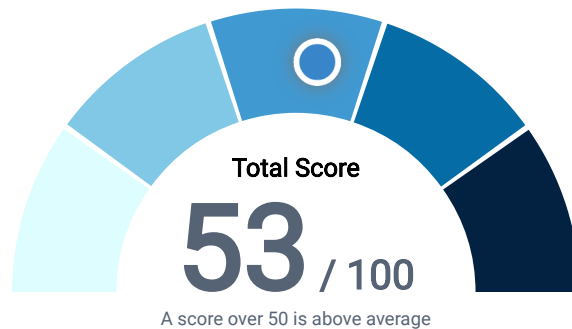

<b>Housing</b>	<b>52</b>
Affordability & Access	
<b>Neighborhood</b>	<b>49</b>
Access to Life, Work & Play	
<b>Transportation</b>	<b>42</b>
Safe & Convenient Options	
<b>Environment</b>	<b>59</b>
Clean Air & Water	
<b>Health</b>	<b>62</b>
Prevention, Access & Quality	
<b>Engagement</b>	<b>47</b>
Civic & Social Involvement	
<b>Opportunity</b>	<b>58</b>
Inclusion & Possibilities	

# Property Photos





# Historical Photos

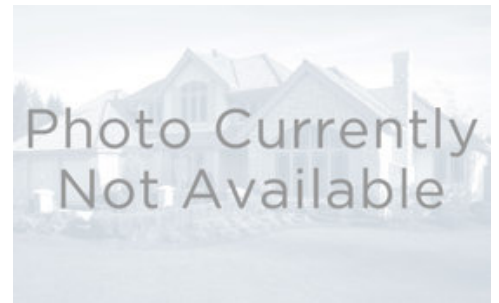
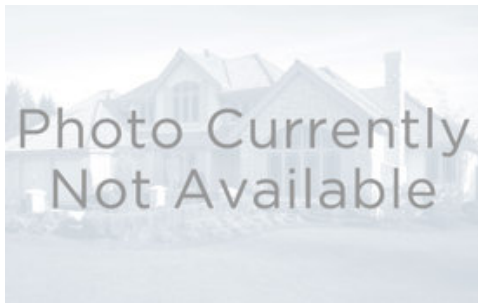
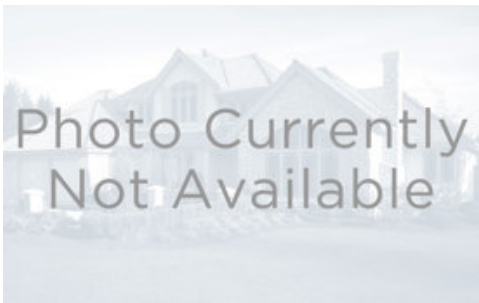
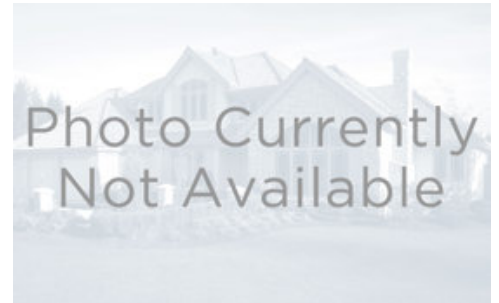
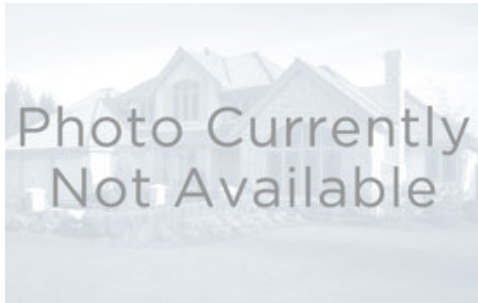
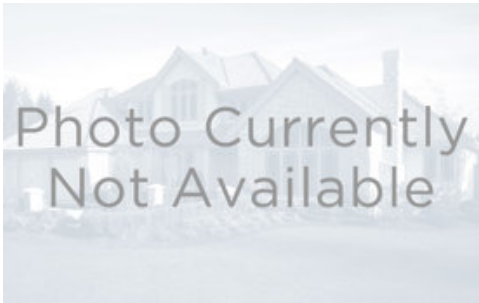



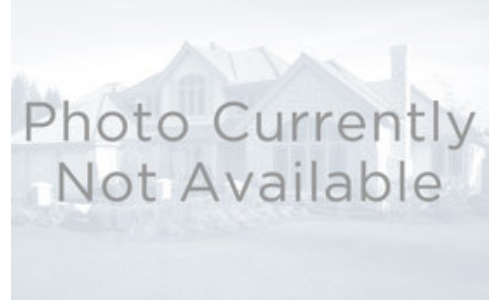
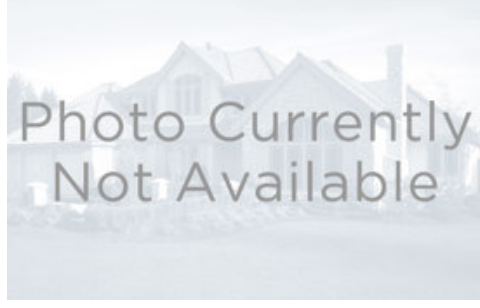
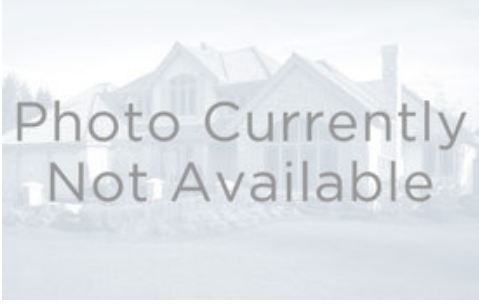
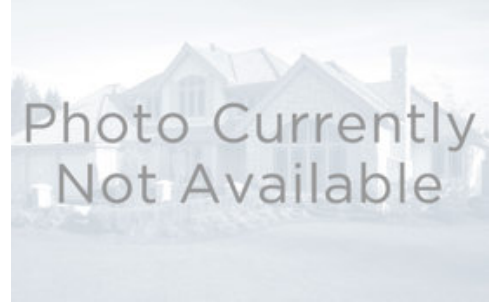
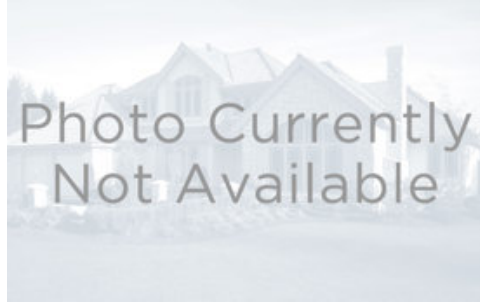
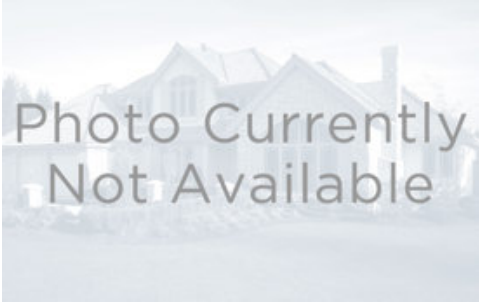

# Comps and Adjustments

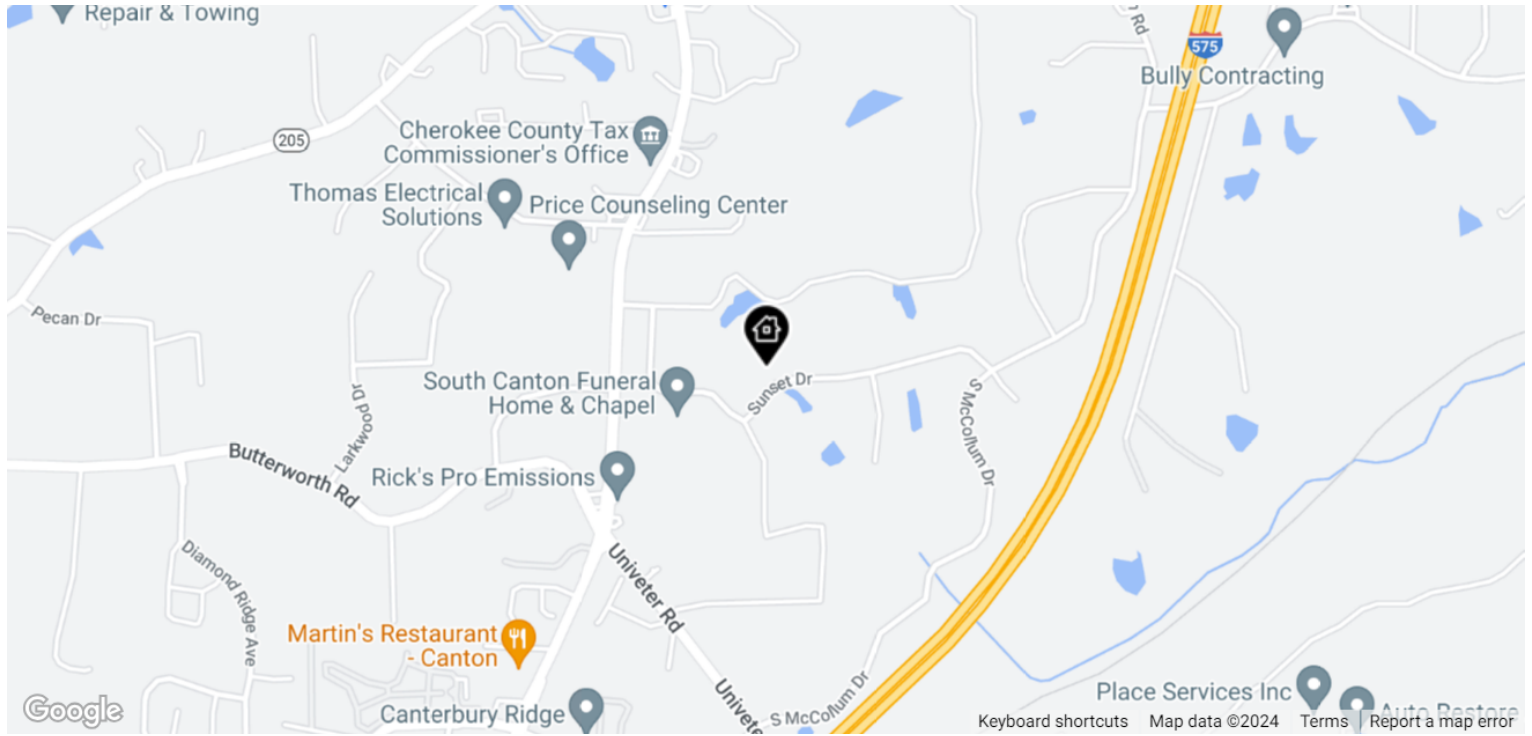

LEGEND: Subject Property Pending For Sale or For Lease Distressed Recent Sale Off Market

## This Property



**Active**

419 Sunset Dr  
Canton, GA 30114

Proxim.	Days in RPR	Date	Amount	\$/sq ft	Living Area	Lot Size	Beds	Baths	Built
-	1 day	-	-	\$188	4,510 sq ft	5.53 acres	3	3	1955

No comps have been selected for this property.

## Property History

### Median Estimated Home Value

This graphic displays property estimates for a market area and a subject property, where one has been selected. Estimated property values are generated by a valuation model and are not formal appraisals.

Data Source: Public records, and MLS sources where licensed

Update Frequency: Monthly

- This Property
- Canton
- Cherokee County
- Georgia

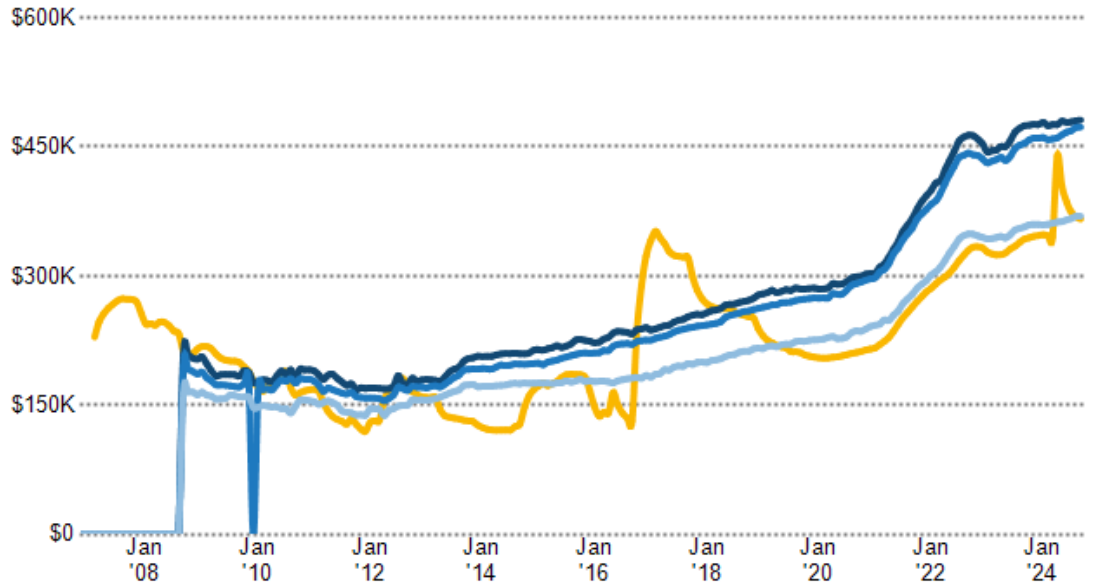

### Sales History

Sales Date	Sales Amount	Price per sq. ft.
9/29/2017	\$270,000	\$59
6/9/2010	\$100,800	\$22

### Assessed Values

Date	Improvements	Land	Total	Tax
2023	\$120,484	\$37,920	\$158,404	\$3,935
2022	\$95,824	\$37,920	\$133,744	\$3,685
2021	\$86,404	\$37,920	\$124,324	\$3,529
2020	\$75,664	\$37,920	\$113,584	\$3,227
2019	\$62,920	\$37,920	\$100,840	\$2,865
2018	\$56,320	\$37,920	\$94,240	\$2,694
2017	\$55,600	\$37,920	\$93,520	—
2016	\$40,520	\$37,920	\$78,440	\$730
2015	\$39,640	\$37,920	\$77,560	\$739
2014	\$38,760	\$37,920	\$76,680	\$731
2013	\$34,560	\$35,640	\$70,200	\$669
2012	—	—	\$179,400	—
2011	—	—	\$184,200	\$646
2010	\$46,240	\$42,920	\$89,160	\$714
2009	\$52,480	\$42,920	\$95,400	—
2008	\$57,480	\$42,920	\$100,400	—
2007	\$58,760	\$42,920	\$101,680	—
2006	\$57,840	\$42,920	\$100,760	—
2005	\$59,040	\$33,080	\$92,120	—

### Legal Description

APN	14N18C 053
Tax ID	397570
Zoning	R-20
Census Tract	130570906.061013
Abbreviated Description	CITY/MUNI/TWP:UNINCORPORATED AREA LL 18 DIST. 15
City/Municipality/Township	Canton, GA 30114

## Mortgage Records

<b>Recording Date</b>	11/6/2017
<b>Borrower Name</b>	CHRISTOPHER WILLIAMS, PATRICIA WILLIAMS
<b>Lender Name</b>	EVERETT FINANCIAL
<b>Lender Type</b>	Mortgage company
<b>Loan Amount</b>	\$100,000
<b>Document Number</b>	2017039689
<b>Loan Type</b>	New Conventional
<b>Contract Date</b>	9/29/2017
<b>Due Date</b>	10/1/2047

## Deed Records

<b>Recording Date</b>	9/29/2017
<b>Document Type</b>	Warranty Deed
<b>Sales Price</b>	\$270,000
<b>Sales Price Code</b>	Full amount stated on Document
<b>Buyer Name</b>	Christopher Williams, Patricia A WILLIAMS
<b>Buyer ID</b>	Individual(s)
<b>Seller Name</b>	Wilbur S HATTENDORF
<b>Seller ID</b>	Individual(s)
<b>Document #</b>	2017-011601
<b>Book #</b>	14225
<b>Page #</b>	19
<b>Contract Date</b>	9/29/2017

### Sales and Financing Activity

This chart shows a property's sales and financing history. It can be used to compare the value of the property as seen by public records, such as deeds and tax records, with the estimated home value. Actions taken against the owner, such as the issuance of a Notice of Default, are noted. Sales activity, such as listing date and price reductions, are highlighted.

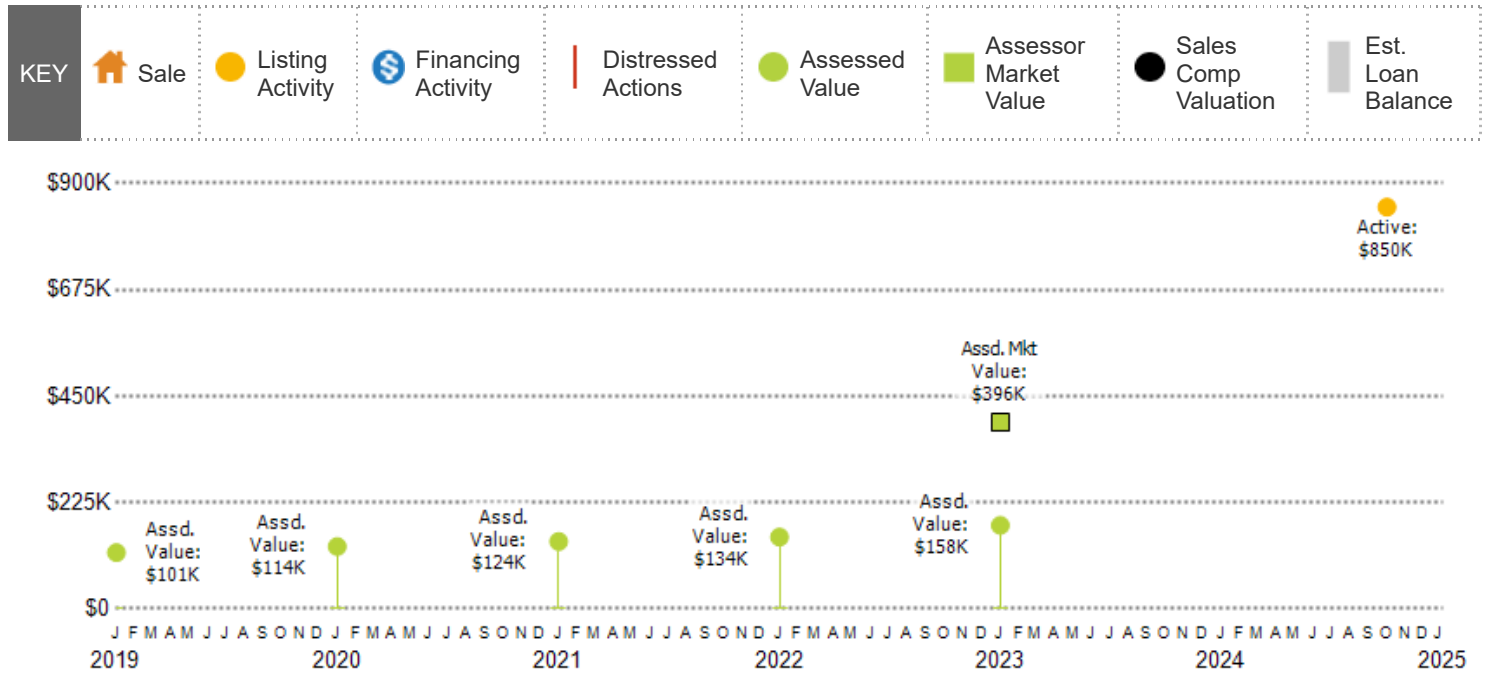

Data Source: Public Record and Listing data

Update Frequency: Valuations are updated twice monthly; actions on the home, such as listing activity or distressed property notices, are updated daily as made available from public records sources

### Price Change History

Change Date	Description	New List Price	% Change
10/8/2024	Active	\$850,000	-

## Neighborhood: Housing Stats and Charts

	30114	Cherokee County	Georgia	USA
<b>Median Estimated Home Value</b>	\$481K	\$473K	\$365K	\$367K
<b>Estimated Home Value 12-Month Change</b>	+1.8%	+4.5%	+4.9%	+4.5%
<b>Median List Price</b>	\$547K	\$570K	\$393K	–
<b>List Price 1-Month Change</b>	+1%	+2.1%	+0.8%	–
<b>List Price 12-Month Change</b>	+1.9%	+3.6%	+6.2%	–
<b>Median Home Age</b>	24	26	36	43
<b>Own</b>	68%	77%	65%	65%
<b>Rent</b>	32%	23%	35%	35%
<b>\$ Value of All Buildings for which Permits Were Issued</b>	–	\$923M	\$14.7B	\$365B
<b>% Change in Permits for All Buildings</b>	–	-13%	-6%	-6%
<b>% Change in \$ Value for All Buildings</b>	–	+8%	-8%	-5%

### Median Estimated Home Value vs. Median Listing Price

This chart compares a ZIP code's median estimated home value with the median listing price of Active listings. Estimated home values are generated by a valuation model and are not formal appraisals.

Data Source: Public Record and Listing data

Update Frequency: Monthly

■ Median Estimated Value  
■ Median List Price

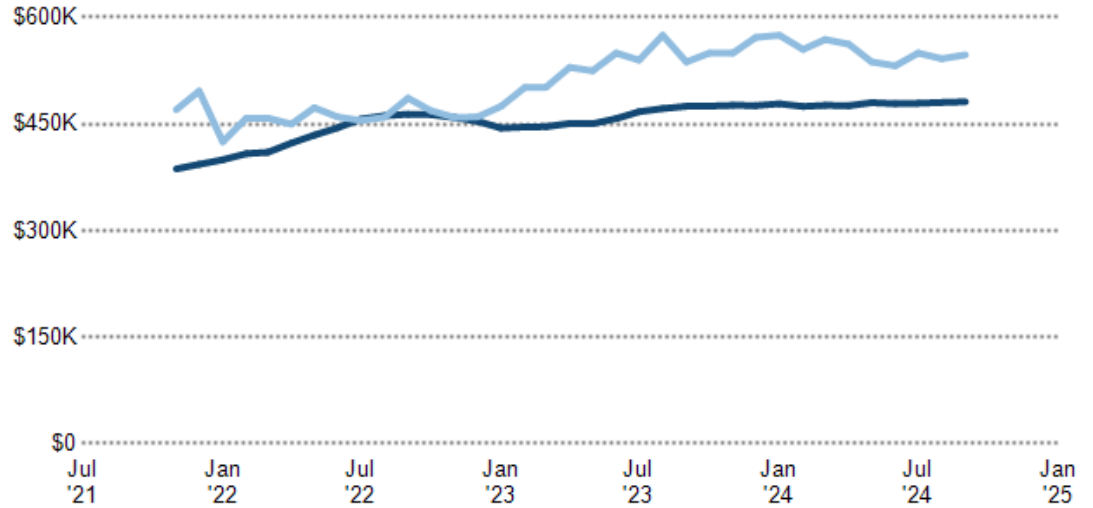

## Median Sales Price vs. Sales Volume

This chart compares the listings and public records sales price trend and sales volume for homes in an area.

Data Source: Public Record and Listing data

Update Frequency: Monthly

- Median Sales Price Public Records
- Median Sales Price Listings
- Sales Volume Public Records
- Sales Volume Listings

Median Sales Price

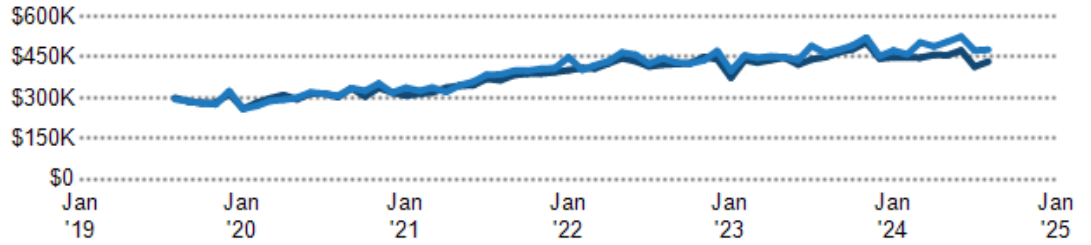

Sales Volume

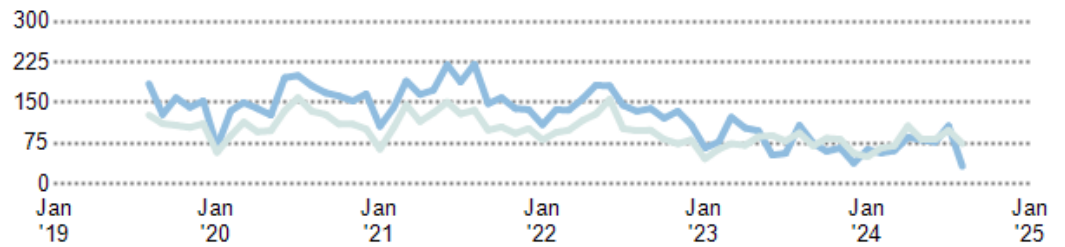

## Median Listing Price vs. Listing Volume

This chart compares the listings and public records sales price trend and sales volume for homes in an area.

Data Source: Public Record and Listing data

Update Frequency: Monthly

- Median List Price
- Listing Volume

Median List Price

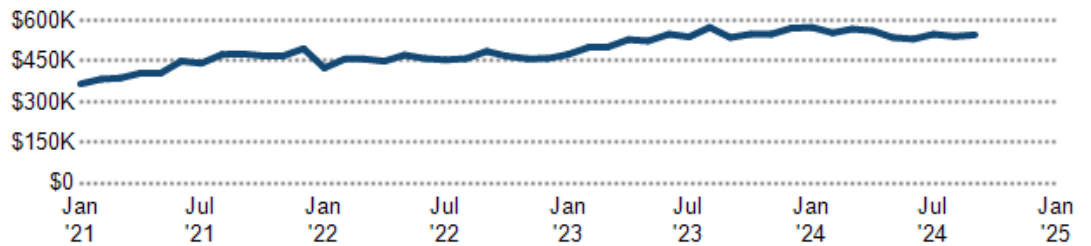

Listing Volume

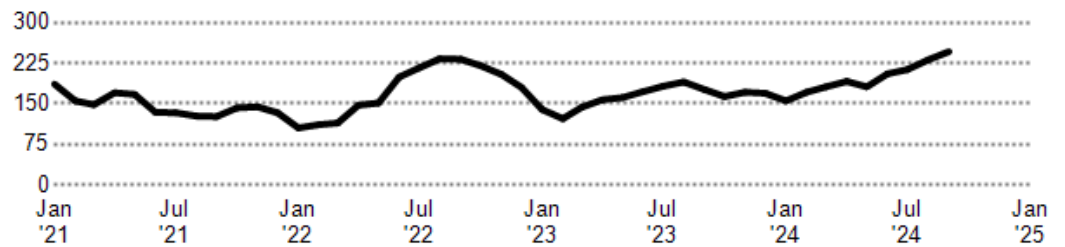

## Listing Inventory

This chart shows the number of For Sale listings in a ZIP code by Property Type.

Data Source: On- and off-market listings sources

Update Frequency: Daily

- ZIP Count Listings by PropertyType



## Median Sales Price by Square Footage



This chart shows the median price of homes reported sold in the past six months, according to the size of the living space (square footage sourced from public records). The amount shown for the subject property is sold data where available, or the property's estimated value when sales data are unavailable (such as non-disclosure states) or provided in range format.

Data Source: Public records and MLS data where licensed

Update Frequency: Monthly

■ Comps

## Price per Bedroom of Comps Sold



This chart shows the distribution of homes reported sold in the past six months at different prices per bedroom in the area of your search. The amount shown for the subject property is sold data where available, or the property's estimated value when sales data are unavailable (such as a non-disclosure state) or provided in range format.

Data Source: Public records and MLS data where licensed

Update Frequency: Monthly

■ Comps

## Price per Square Foot of Comps Sold



This chart shows the distribution of homes reported sold in the past three months at different prices per square foot.

Data Source: Public records data

Update Frequency: Daily

■ Comps



## Price Range of Comps Sold



This chart shows the distribution of homes reported sold in the past three months within different price ranges in the area of your search. The amount shown for the subject property is sold data where available, or the property's estimated value when sales data is unavailable (such as a non-disclosure state) or provided in range format.

Data Source: Public records data  
Update Frequency: Daily

■ Comps

## Age Range of Comps Sold

This chart shows the distribution of homes reported sold in the past three months of different age ranges in the area of your search.

Data Source: Public records data  
Update Frequency: Daily

■ This Property  
■ Comps

### This Property



### Comps



## Size of Homes Sold

This chart shows the distribution of homes reported sold in the past three months of different sizes in the area of your search.

Data Source: Public records data  
Update Frequency: Daily

■ Sales Count By Living Area



## Number of Bedrooms in Homes Sold

This chart shows the distribution of homes reported sold in the past three months, compared by the number of bedrooms, in the area of your search.

Data Source: Public records data  
Update Frequency: Daily

■ Sales Count by Bedroom

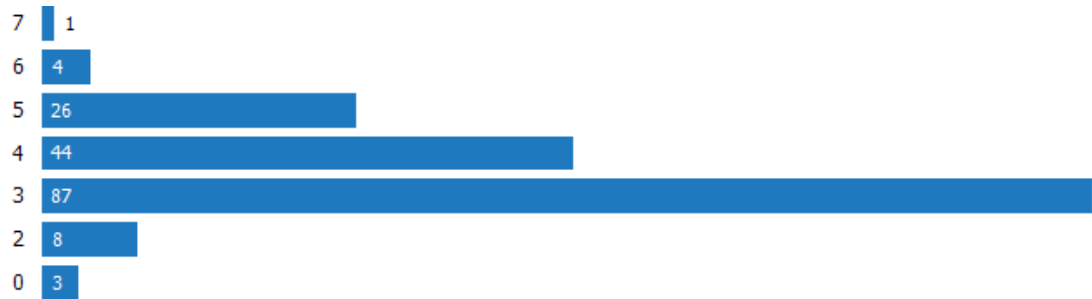

## Neighborhood: People Stats and Charts

	<b>30114</b>	<b>Cherokee County</b>	<b>Georgia</b>	<b>USA</b>
<b>Population</b>	56.9K	269K	10.7M	331M
<b>Population Density per Sq Mi</b>	708	638	186	93.6
<b>Population Change since 2020</b>	+0.1%	+0.1%	+3%	0%
<b>Median Age</b>	39	40	37	39
<b>Male / Female Ratio</b>	51%	50%	49%	50%

## Education Levels of Population

This chart shows the educational achievement levels of adults in an area, compared with other geographies.

Data Source: U.S. Census American Community Survey via Esri, 2021

Update Frequency: Annually

### Less Than 9th Grade

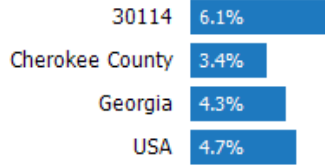

### 9-12th Grade/No Diploma

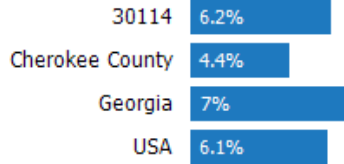

### High School Graduate



### Associate Degree



### Bachelor's Degree



### At Least a College Education



### Grad/Professional Degree

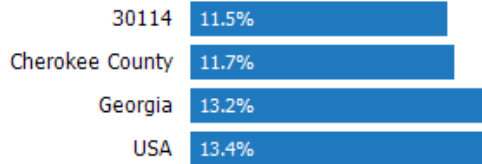

## Population of Children by Age Group

This chart shows the distribution of the population of children by age range — from birth to 17 — in the area of your search.

Data Source: U.S. Census

Update Frequency: Annually

30114



## Population of Adults by Age Group

This chart shows the distribution of the population of adults by age range — from 18 to 75-plus — in the area of your search.

Data Source: U.S. Census

Update Frequency: Annually

30114



## Households With Children

This chart shows the distribution of households with children, categorized by marital status, in the area of your search.

Data Source: U.S. Census

Update Frequency: Annually

30114



## Household Income Brackets

This chart shows annual household income levels within an area.

Data Source: U.S. Census

Update Frequency: Annually

30114

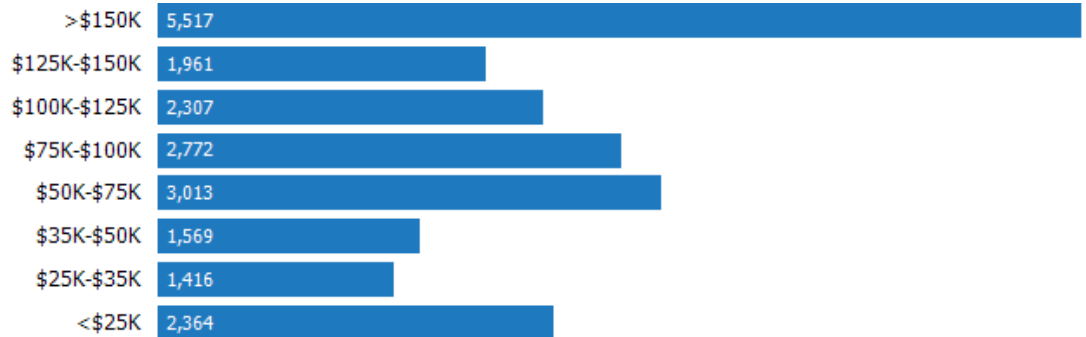

## Presidential Voting Pattern

This chart shows how residents of a county voted in the 2020 presidential election.

Data Source: USElectionAtlas.org

Update Frequency: Quadrennially



Cherokee County

# Neighborhood: Economic Stats and Charts

	30114	Cherokee County	Georgia	USA
<b>Income Per Capita</b>	\$44,934	\$45,334	\$37,836	\$41,261
<b>Median Household Income</b>	\$93,917	\$100,824	\$71,355	\$75,149
<b>Unemployment Rate</b>	–	3.2%	3.2%	4.3%
<b>Unemployment Number</b>	–	4.75K	173K	7.16M
<b>Employment Number</b>	–	144K	5.23M	161M
<b>Labor Force Number</b>	–	148K	5.4M	168M

## Unemployment Rate

This chart shows the unemployment trend in the area of your search. The unemployment rate is an important driver behind the housing market.

Data Source: Bureau of Labor Statistics

Update Frequency: Monthly

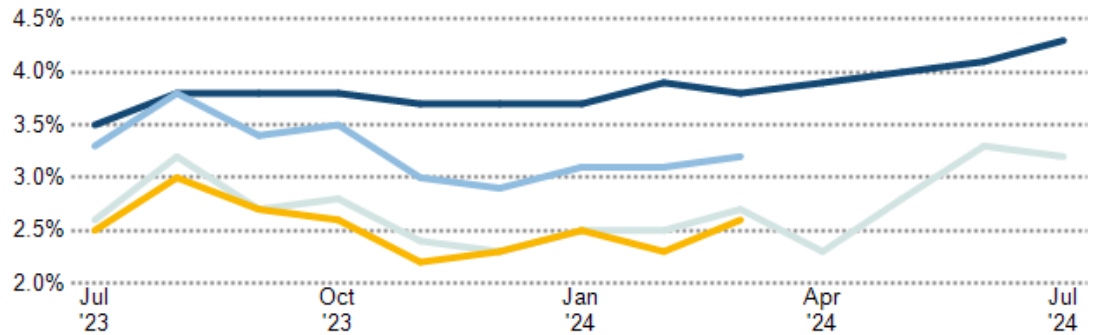

## Occupational Categories

This chart shows categories of employment within an area.

Data Source: U.S. Census

Update Frequency: Annually



## Neighborhood: Quality of Life Stats and Charts

### Quality of Life in 30114

	30114	Cherokee County	Georgia	USA
Elevation (in feet)	1,056	1,068	497	–
Annual Rainfall (in inches)	60	60	52.95	–
Annual Snowfall (in inches)	1.56	1.57	1.63	–
Days of Full Sun (per year)	113	112	109	–
Travel Time to Work (in minutes)	–	33	28	27
Water Quality - Health Violations	–	–	–	–
Water Quality - Monitoring and Report Violations	–	–	–	–
Superfund Sites	0	0	27	2,438
Brownfield Sites	No	No	Yes	Yes

### Average Commute Time

This chart shows average commute times to work, in minutes, by percentage of an area's population.

Data Source: U.S. Census

Update Frequency: Annually



30114

### How People Get to Work

This chart shows the types of transportation that residents of the area you searched use for their commute.

Data Source: U.S. Census

Update Frequency: Annually



30114

### Average Monthly Temperature

This chart shows average temperatures in the area you searched.

Data Source: NOAA

Update Frequency: Annually



30114

## School: Hasty Elementary School

### School Details

**Name**  
Hasty Elementary School

**Level**  
Elementary

**Type**  
Public

**Grades Served**  
PK, K-5

**School District**  
Cherokee County  
Schools

**Address**  
205 Brown Industrial  
Pkwy, Canton, GA 30114

**Phone**  
(770) 721-6555

### School Facts

### Hasty Elementary School

### Cherokee County Schools

#### Overall Grade



Total Enrollment

1,064

41,891

Students per Teacher

11:1

17:1

Students in Free Lunch Program

75%

30%

#### Academic Grade



Average GPA

–

3.54 (out of 7652 responses)

Math Proficiency

39%

51%

Reading Proficiency

28%

49%

Gifted Students

2%

–

AP Enrollments

–

–

Graduation Rate

–

91%

Average ACT Score

–

26 (out of 1783 responses)

Average SAT Score

–

1,200 (out of 2482 responses)

#### Teacher Grade



Average Teacher Salary

\$63,103

\$63,103

Teachers in 1st or 2nd Year

8%

6%

*About this data: Facts and proficiency scores are provided by Niche, which compiles scores, community reviews and other data about schools across the United States. Ratings for this school are based on the most recent available facts for each school and district. Data compiled from the U.S. Department of Education, Private School Universe Survey, Common Core Data and others. Source: Niche Update Frequency: Quarterly*



## School: Teasley Middle School

### School Details

**Name**  
Teasley Middle School

**Level**  
Middle

**Type**  
Public

**Grades Served**  
6-8

**School District**  
Cherokee County  
Schools

**Address**  
151 Hickory Log Dr,  
Canton, GA 30114

**Phone**  
(770) 721-5420

### School Facts

#### Teasley Middle School

#### Cherokee County Schools

#### Overall Grade



Total Enrollment

1,606

41,891

Students per Teacher

13:1

17:1

Students in Free Lunch Program

52%

30%

#### Academic Grade



Average GPA

–

3.54 (out of 7652 responses)

Math Proficiency

31%

51%

Reading Proficiency

31%

49%

Gifted Students

7%

–

AP Enrollments

–

–

Graduation Rate

–

91%

Average ACT Score

–

26 (out of 1783 responses)

Average SAT Score

–

1,200 (out of 2482 responses)

#### Teacher Grade



Average Teacher Salary

\$63,103

\$63,103

Teachers in 1st or 2nd Year

2%

6%

*About this data: Facts and proficiency scores are provided by Niche, which compiles scores, community reviews and other data about schools across the United States. Ratings for this school are based on the most recent available facts for each school and district. Data compiled from the U.S. Department of Education, Private School Universe Survey, Common Core Data and others. Source: Niche Update Frequency: Quarterly*

## Community Reviews for this School

Posted: 2/16/2020 by Parent

I have 2 children that have attended Teasley and could not be happier with the education they have received.

## School: Cherokee High School

### School Details

**Name**  
Cherokee High School

**Level**  
High

**Type**  
Public

**Grades Served**  
9-12

**School District**  
Cherokee County Schools

**Address**  
930 Marietta Hwy,  
Canton, GA 30114

**Phone**  
(770) 721-5300

### School Facts

#### Overall Grade



### Cherokee High School



### Cherokee County Schools

Total Enrollment

2,937

41,891

Students per Teacher

15:1

17:1

Students in Free Lunch Program

38%

30%

#### Academic Grade



Average GPA

3.52 (out of 1429 responses)

3.54 (out of 7652 responses)

Math Proficiency

46%

51%

Reading Proficiency

45%

49%

Gifted Students

12%

–

AP Enrollments

–

–

Graduation Rate

85%

91%

Average ACT Score

26 (out of 372 responses)

26 (out of 1783 responses)

Average SAT Score

1,200 (out of 365 responses)

1,200 (out of 2482 responses)

#### Teacher Grade



Average Teacher Salary

\$63,103

\$63,103

Teachers in 1st or 2nd Year

5%

6%

*About this data: Facts and proficiency scores are provided by Niche, which compiles scores, community reviews and other data about schools across the United States. Ratings for this school are based on the most recent available facts for each school and district. Data compiled from the U.S. Department of Education, Private School Universe Survey, Common Core Data and others.  
Source: Niche Update Frequency: Quarterly*

## Community Reviews for this School

Posted: 6/27/2024 by Alum

My teachers were, for the most part, absolutely wonderful and incredibly caring. Teachers like Ms. Hall, Ms. Mathews, Mr. EJ, Ms. Pangburn, and Ms. Birdwell are incredibly passionate about teaching students and giving them the best possible learning experience. The experience around other students is another story. Many students were outwardly racist or held nazi ideologies and were not shy about it. Bullying was incredibly common, but if you kept quiet you could typically avoid too much of it. Many students are also very kind and friendly, it really depends on who you get involved with. Also a decent amount of drug use, almost always encountered girls vaping in the bathrooms when I just needed to pee. Cherokee was always dirty and often you would see cockroaches or mice, not by any fault of the janitors. Mostly the fault of students not respecting the environment around them.

---

Posted: 6/17/2024 by Senior

My worst experience would be the unsanitized restrooms that always lacks soap and students be smoking in the stalls. My best experience would be bonding with my teachers.

---

Posted: 5/5/2024 by Alum

I transferred my Junior year, but this school helped change my life. The high I was at previously was not very safe or accepting and I was bullied a lot. Cherokee helped me become who I am today!

---

Posted: 5/2/2024 by Senior

Administration and the information they give to students, parents, and teachers is incomplete and often favors the option that will give them money as opposed to what will actually help students. The lack of informed staff and students because of this is appalling and not only is it decreasing the amount of graduates, it is also decreasing school ratings and property values.

---

Posted: 5/2/2024 by Senior

The best part of my High school experience is being able to play all 4 years in the soccer team. The worst parts is having digital days.

## About RPR (Realtors Property Resource)

- Realtors Property Resource® is a wholly owned subsidiary of the National Association REALTORS®.
- RPR offers comprehensive data – including a nationwide database of 164 million properties – as well as powerful analytics and dynamic reports exclusively for members of the NAR.
- RPR's focus is giving residential and commercial real estate practitioners, brokers, and MLS and Association staff the tools they need to serve their clients.
- This report has been provided to you by a member of the NAR.



## About RPR's Data

RPR generates and compiles real estate and other data from a vast array of sources. The data contained in your report includes some or all of the following:

- **Listing data** from our partner MLSs and CIEs, and related calculations, like estimated value for a property or median sales price for a local market.
- **Public records data** including tax, assessment, and deed information. Foreclosure and distressed data from public records.
- **Market conditions and forecasts** based on listing and public records data.
- **Census and employment data** from the U.S. Census and the U.S. Bureau of Labor Statistics.
- **Demographics and trends data** from Esri. The data in commercial and economic reports includes Tapestry Segmentation, which classifies U.S. residential neighborhoods into unique market segments based on socioeconomic and demographic characteristics.
- **Business data** including consumer expenditures, commercial market potential, retail marketplace, SIC and NAICS business information, and banking potential data from Esri.
- **School data and reviews** from Niche.
- **Specialty data sets** such as walkability scores, traffic counts and flood zones.



## Update Frequency

- Listings and public records data are updated on a continuous basis.
- Charts and statistics calculated from listing and public records data are refreshed monthly.
- Other data sets range from daily to annual updates.

## Learn more

For more information about RPR, please visit RPR's public website: <https://blog.narrpr.com>

